

ILFORD MULTIGRADE 500

ADAPTOR KIT
FOR
THE LEITZ IIC
ENLARGER

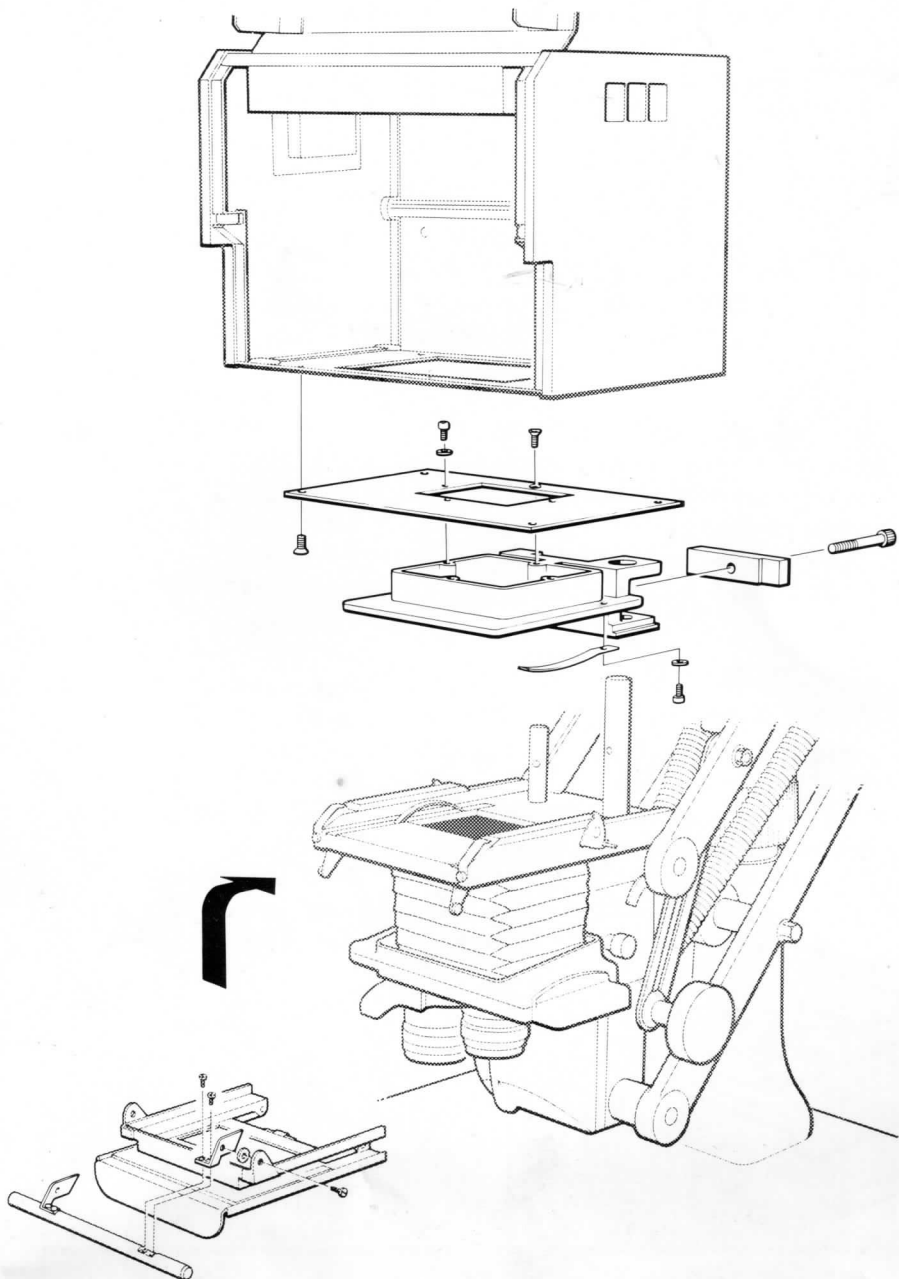

DIFFUSER

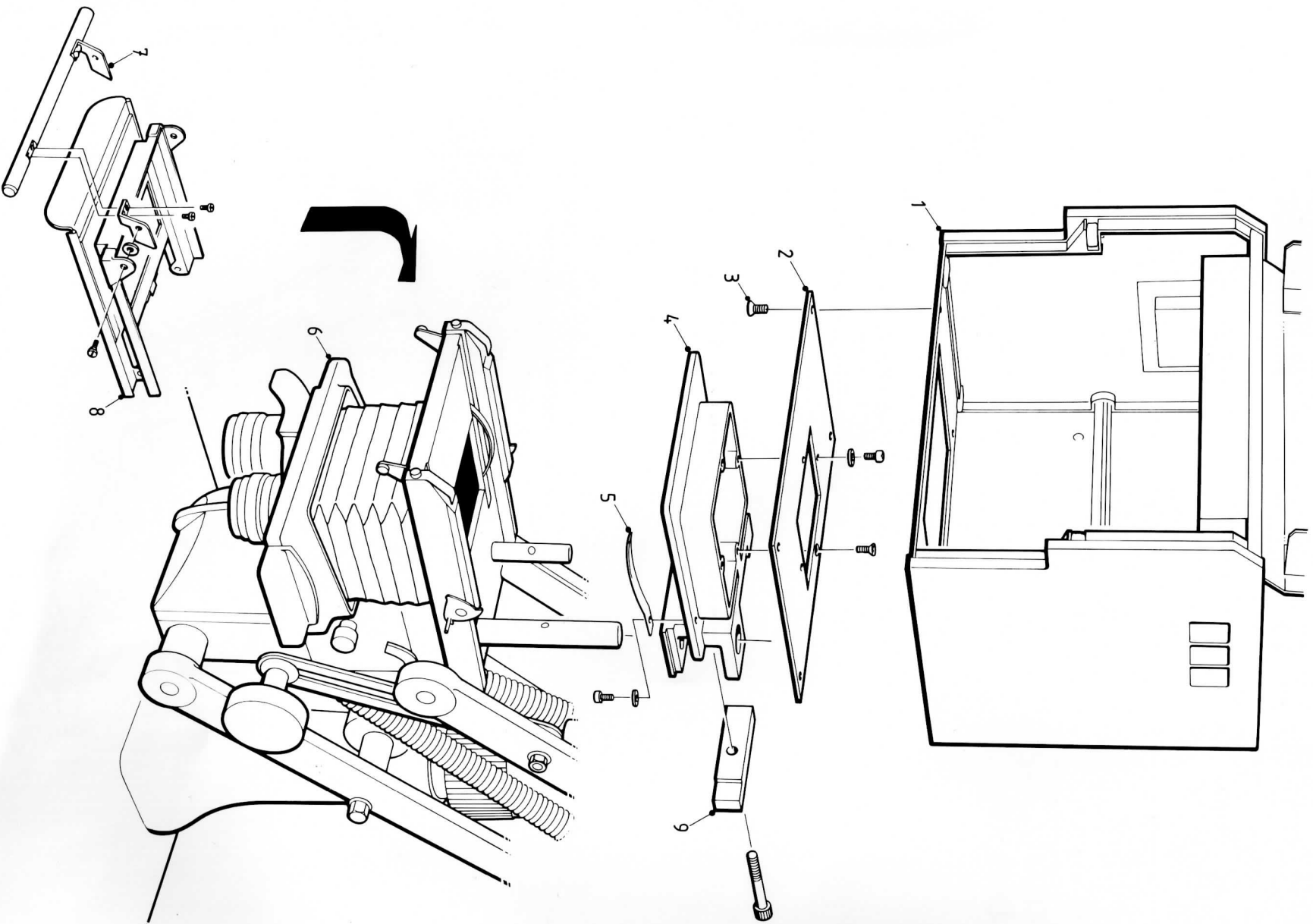

Figure 1.1

- 1 MULTIGRADE 500H enlarger head
- 2 Bottom closing plate
- 3 Securing screw - bottom closing plate
- 4 Support casting
- 5 Spring clip
- 6 Leitz IIC chassis
- 7 Replacement lever bracket
- 8 Negative carrier
- 9 Clamping bar

1.1 Introduction

The adaptor kit (see figure 1.1) enables the ILFORD MULTIGRADE 500H enlarger head to be fitted to the Leitz IIC enlarger. Installation is straightforward provided the instructions in this leaflet are carefully followed. If you have any problems, please contact your nearest ILFORD selling company, the address of which can be found on the back cover of this leaflet.

Two adaptor kits have been designed to enable the MULTIGRADE 500H enlarger head to be fitted to the Leitz IIC enlarger. The selection of the most appropriate adaptor kit depends on whether diffuse or condensed light is preferred. With this adaptor kit, the original enlarger condensers are not required and the MULTIGRADE 500 assembly supplies diffuse light.

Information regarding the fitting and changing of light mixing boxes is detailed in the MULTIGRADE 500 Operating manual, which must be read thoroughly before the equipment is used.

WARNING

To prevent irreparable damage to the equipment, do not use force when carrying out any of the following instructions. Because the lamp slides are free to move, handle the MULTIGRADE 500H enlarger head with extreme care. Remove the lamps if you feel it is necessary.

1.2 Unpacking

The adaptor kit for the Leitz IIC enlarger consists of the sub-assemblies detailed in table 1.1. Each sub-assembly is packed in a plastic bag, with the part number written on the bag. Please ensure you have all the correct items before proceeding with any of the fitting instructions (see also figure 1.1).

Table 1.1 Adaptor kit

Part no.	Description
6069-2-106	Register plate, 35mm
6069-2-107	Register plate, 6x7cm
6091-3-004	Light mixing box, 35mm
6092-3-004	Light mixing box, 6x7cm
6069-2-111	Bottom closing plate
6098-P-002	Sub kit

The sub kit, part number 6098-P-002, consists of the items detailed in table 1.2.

Note

Two of each of the items marked * are supplied; one set for the 35mm negative carrier and one set for the 6x7cm negative carrier.

Table 1.2 Sub kit 6098-P-002

Description	Quantity
*Replacement lever bracket (left hand)	2
*Replacement lever bracket (right hand)	2
Support casting	1
Clamping bar	1
Spring clip	2
Socket wrench, 5mm	1
Screw, M3x5mm, pan head	2
Screw, M3x10mm, pan head	3
Screw, M3x10mm, countersunk head	1
Washer, M3, plain	5
Screw, M6x40mm, socket head	1

1.3 Removing the Leitz enlarger head

The Leitz IIC enlarger head is counter balanced to be moved up and down with the minimum of effort. Before proceeding, ensure the chassis is positioned at a convenient working height and securely locked.

WARNING

Never lean over counter balanced enlargers; failure of the locking mechanism could cause injury.

To remove the Leitz enlarger head, proceed as follows (refer also to the manufacturer's literature):

- 1 Remove the negative carrier.
- 2 Release the large knurled knob, located on the right hand side of the enlarger head. Lift the head off the chassis.

2

FITTING THE MULTIGRADE 500H ENLARGER HEAD

With the Leitz enlarger head removed, the enlarger is ready to accept the MULTIGRADE 500H enlarger head.

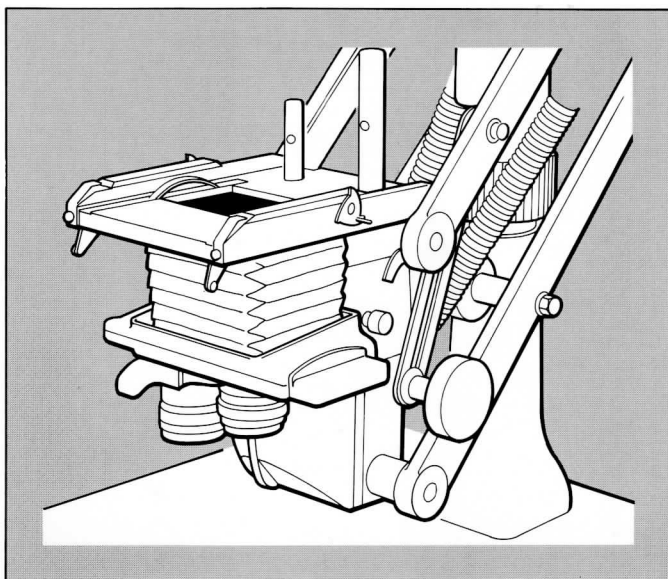

1

Secure the two spring clips to the support casting with the two M3x5mm pan head screws and associated washers. Secure the support casting to the bottom closing plate with the M3x10mm countersunk head screw, and the three M3x10mm pan head screws.

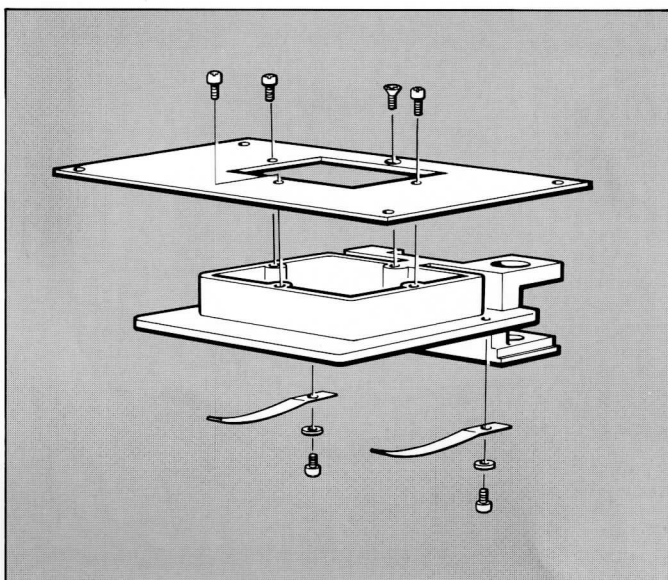

2

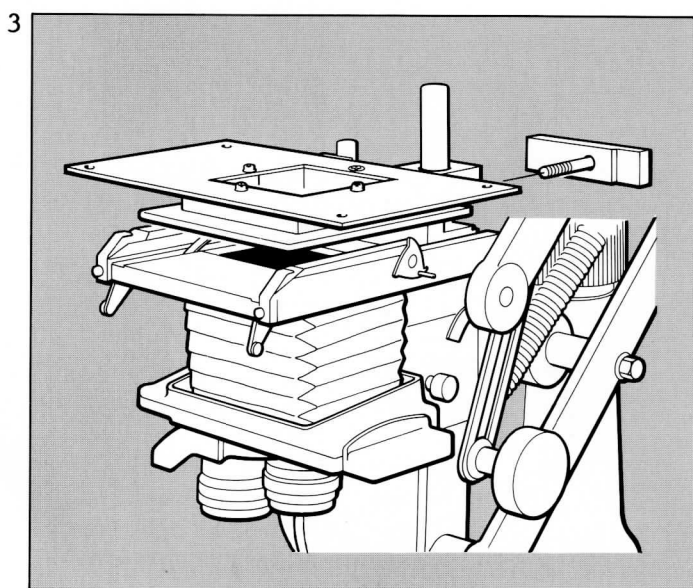

Locate the support casting assembly onto the chassis and secure in position with the clamping bar and the M6x40mm socket head screw, using the socket wrench provided.

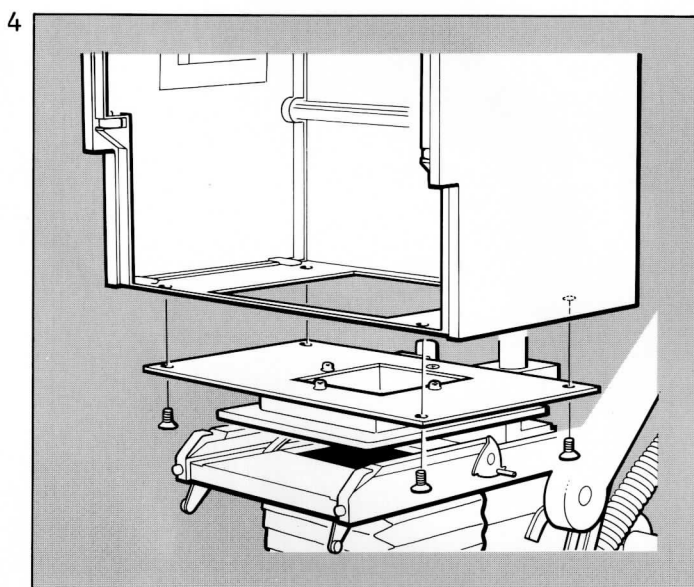

Position the MULTIGRADE 500H enlarger head upside down on a bench. Remove the four countersunk head screws and associated cup washers from the base. Discard the cup washers.

Secure the enlarger head to the bottom closing plate using the four countersunk head screws removed above.

Modify the negative carrier. Remove the lifting bar assembly by releasing the two pivot screws and washers. Separate the lever brackets from the lifting bar by releasing the four screws, two on each bracket. Re-assemble using one set of the replacement lever brackets for each of the two negative carriers.

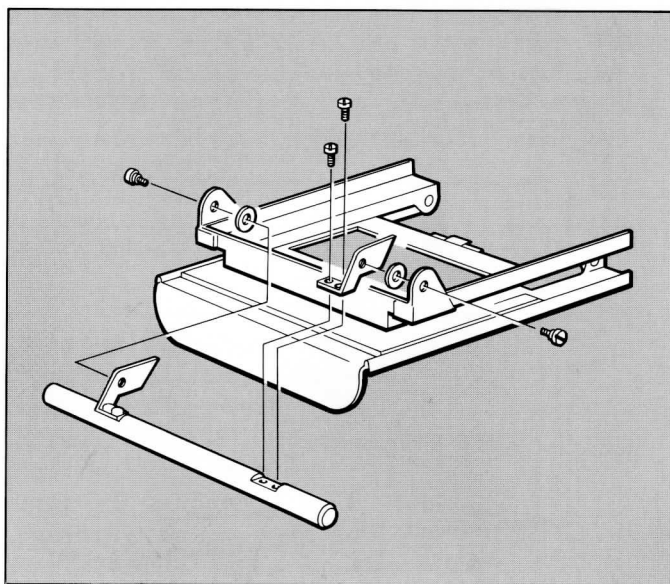

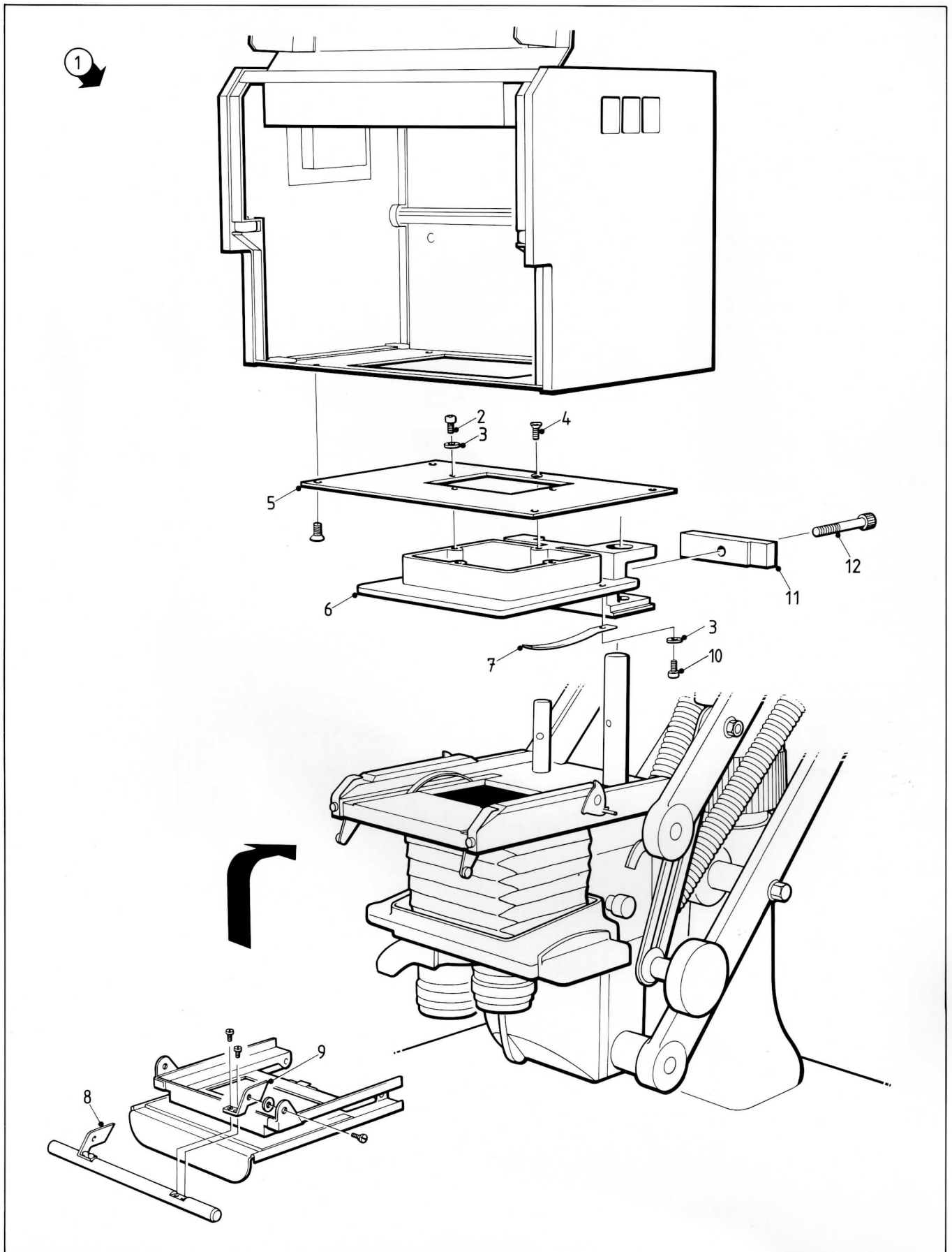

Figure 3.1

3 PARTS LIST

Figure 3.1 and the following table detail all spare parts that are available. When ordering spare parts, please quote the part number in order that ILFORD Limited may process your order quickly and efficiently.

Ref no. on figure 3.1	Part no.	Description	Quantity
1	6098-P-001	Adaptor kit, complete	
2	87992724	Screw, M3x10mm, pan head	3
3	89730453	Washer, M3, plain	5
4	87990422	Screw, M3x10mm, countersunk head	1
5	6069-2-111	Bottom closing plate	1
6	6098-1-100	Support casting	1
7	6034-3-108	Spring clip	2
8	6098-3-102	Replacement lever bracket (left hand)	2
9	6098-3-103	Replacement lever bracket (right hand)	2
10	87992721	Screw, M3x5mm, pan head	2
11	6098-3-101	Clamping bar	1
12	87992550	Screw, M6x40mm, socket head	1
13+	80004001	Socket wrench, 5mm	1
14+	6069-2-106	Register plate, 35mm	1
15+	6069-2-107	Register plate, 6x7cm	1
16+	6091-3-004	Light mixing box, 35mm, 40mm drop	1
17+	6092-3-004	Light mixing box, 6x7cm, 40mm drop	1

Note

Two of each of items 8 and 9 are supplied; one set for the 35mm negative carrier and one set for the 6x7cm negative carrier.

+ items not illustrated.

Australia

ILFORD PHOTO (Australia) Pty Ltd
PO Box 144
Mt Waverley
3149 Victoria

Austria

CIBA-GEIGY Ges.mbh
Division ILFORD PHOTO
Breitenfurterstraße 251
A-1231 Wien

Belgium

SA ILFORD PHOTO NV
39 Kazernelaan
B-1040 Brussel

Canada

ILFORD PHOTO (Canada) Limited
2751 John Street
Markham
Ontario
L3R 2Y8

Denmark

ILFORD PHOTO Akts
Gadelandet 18
DK-2700 Brønshøj

France

ILFORD SA
BP 336
Chemin de la Fouillouse
F-69802 Saint-Priest
Cédex

Germany

ILFORD PHOTO GmbH
Postfach 124
D-6078 Neu-Isenburg

Holland

ILFORD PHOTO BV
Jan Rebelstraat 5
Postbus 9040
1006 AA Amsterdam

Italy

ILFORD PHOTO SpA
Origgio (Va)
Casella Postale 77
I-21047 Saronno

Japan

CIBA-GEIGY (Japan) Limited
ILFORD PHOTO Group
PO Box 32
World Trade Centre Building
105 Tokyo

South Africa

CIBA-GEIGY (Pty) Ltd
ILFORD PHOTO Division
PO Box 92
Isando
Transvaal

Sweden

ILFORD PHOTO AB
Box 3052
S-400 10 Göteborg

Switzerland

ILFORD PHOTO AG
Industriestraße 15
CH-1700 Fribourg 5

United Kingdom

ILFORD PHOTO Company
14-22 Tottenham Street
London W1P 0AH

USA

ILFORD PHOTO Inc
West 70 Century Road
PO Box 288
Paramus
New Jersey 07653

If your country is not
shown here,
please contact:
ILFORD PHOTO International
ILFORD Limited
14-22 Tottenham Street
London W1P 0AH
England